

AXLE/TIRE/VEHICLE HEIGHT DATA SUPER DUTY F-250/350 CREW CAB STYLE SIDE PICKUP — 4X2/4X4

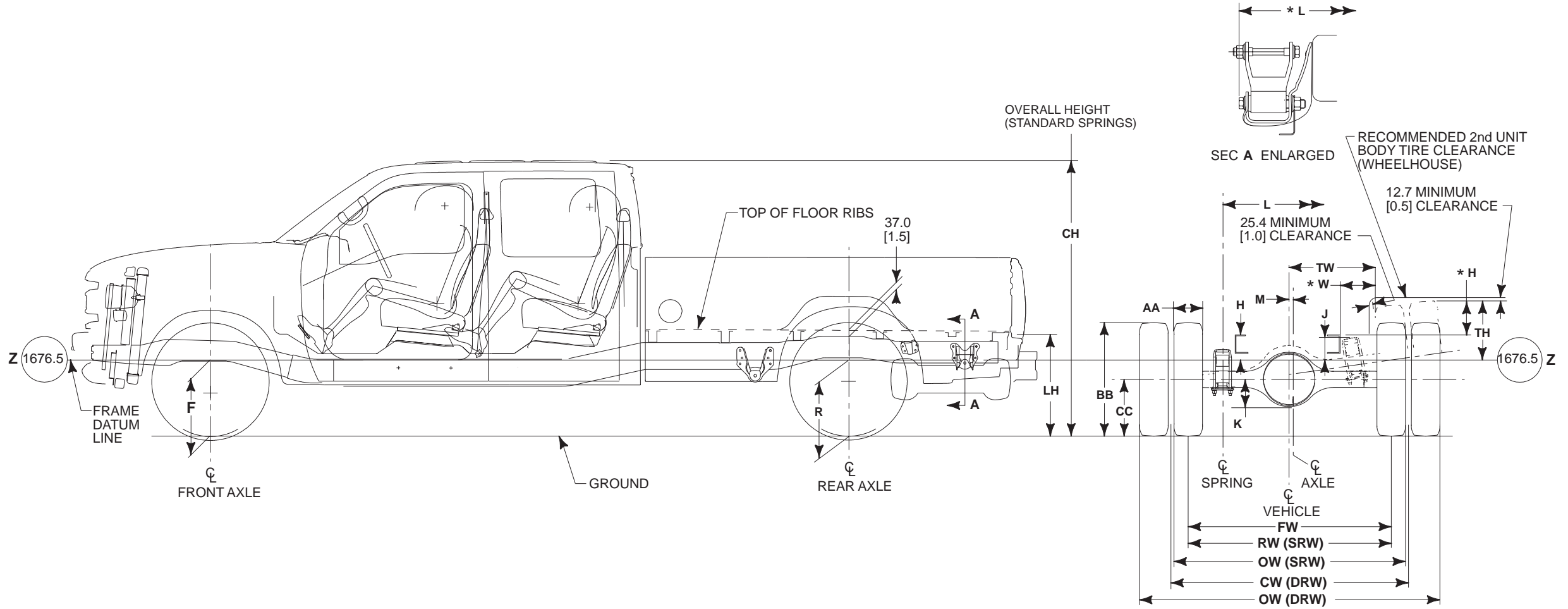

BB0300

NOTES — [] DIMENSIONS ARE IN INCHES.

- F AND R VEHICLE HEIGHT DIMENSIONS ARE FROM GROUND TO FRAME DATUM LINE; LH IS FROM GROUND TO TOP OF FLOOR RIBS.
- *H IS TOP OF FRAME AT CL OF REAR AXLE TO TOP OF TIRE IN JOUNCE
- *L IS FROM OUTSIDE EDGE OF SHACKLE EYEBOLT
- *W IS FROM FRAME TO TOP OF TIRE IN JOUNCE

AXLE/TIRE/VEHICLE HEIGHT DATA SUPER DUTY F-250/350 CREW CAB STYLE SIDE PICKUP — 4X2/4X4

| MODEL | WB | GVWR | BASE TIRE | F HEIGHT AT FRONT WHEEL ⁽⁵⁾ | | R HEIGHT AT REAR AXLE ⁽⁵⁾ | | LH ⁽⁵⁾⁽⁶⁾ | | CH ⁽⁵⁾ | | H | J | K | L | *L | M | AA ⁽⁷⁾ | BB ⁽⁸⁾ | CC ⁽⁸⁾ | FW | RW | OW | CW | TH | *H | TW | *W |
|-------------------------------|--------------|--------------------------|--------------|--|-----------------------|--------------------------------------|-----------------------|----------------------|------------|-------------------|-------------|-----------|------------|-----------|-------------|-------------|----------|-------------------|-------------------|-------------------|-------------|-------------|--------------|-------------|------------|-----------|------------|------------|
| | | | | CURB ⁽³⁾ | LOADED ⁽⁴⁾ | CURB ⁽³⁾ | LOADED ⁽⁴⁾ | EMPTY | LOADED | EMPTY | LOADED | | | | | | | | | | | | | | | | | |
| Super Duty F-250 Crew Cab 4x2 | 3967 [156.2] | 8800 | LT235/85R16E | 533 [21.0] | 515 [20.3] | 624 [24.6] | 505 [19.9] | 847 [33.3] | 696 [27.4] | 1960 [77.2] | 1883 [74.1] | 205 [8.1] | 24 [0.9] | 165 [6.5] | 1143 [45.0] | 1271 [50.0] | 45 [1.8] | 259 [10.2] | 792 [31.2] | 375 [14.8] | 1745 [68.7] | 1729 [68.1] | 1983 [78.1] | — | 390 [15.4] | 233 [9.2] | 716 [28.2] | 254 [10.0] |
| | 4379 [172.4] | | | 530 [20.9] | 515 [20.3] | 622 [24.5] | 505 [19.9] | 842 [33.2] | 698 [27.5] | 1957 [77.0] | 1884 [74.2] | 205 [8.1] | 24 [0.9] | 165 [6.5] | 1143 [45.0] | 1271 [50.0] | 45 [1.8] | 259 [10.2] | 792 [31.2] | 375 [14.8] | 1745 [68.7] | 1729 [68.1] | 1983 [78.1] | — | 390 [15.4] | 233 [9.2] | 716 [28.2] | 254 [10.0] |
| Super Duty F-250 Crew Cab 4x4 | 3967 [156.2] | 8800 | LT235/85R16E | 632 [24.9] | 604 [23.8] | 722 [28.4] | 558 [22.0] | 886 [34.9] | 739 [29.1] | 2027 [79.8] | 1943 [76.5] | 205 [8.1] | 77 @ [3.0] | 165 [6.5] | 1143 [45.0] | 1271 [50.0] | 45 [1.8] | 259 [10.2] | 792 [31.2] | 375 [14.8] | 1736 [68.4] | 1729 [68.1] | 1983 [78.1] | — | 298 [11.7] | 141 [5.6] | 727 [28.6] | 262 [10.3] |
| | 4379 [172.4] | | | 628 [24.7] | 604 [23.8] | 675 [26.5] | 558 [22.0] | 884 [34.8] | 741 [29.1] | 1951 [76.8] | 1883 [74.1] | 205 [8.1] | 77 @ [3.0] | 165 [6.5] | 1143 [45.0] | 1271 [50.0] | 45 [1.8] | 259 [10.2] | 792 [31.2] | 375 [14.8] | 1736 [68.4] | 1729 [68.1] | 1983 [78.1] | — | 298 [11.7] | 141 [5.6] | 727 [28.6] | 262 [10.3] |
| Super Duty F-350 Crew Cab 4x2 | 3967 [156.2] | 9900 ⁽¹⁾ | LT265/75R16E | 532 [20.9] | 515 [20.3] | 624 [24.6] | 505 [19.9] | 847 [33.3] | 697 [27.4] | 1955 [77.0] | 1879 [74.0] | 205 [8.1] | 24 [0.9] | 165 [6.5] | 1143 [45.0] | 1271 [50.0] | 45 [1.8] | 278 [10.9] | 781 [30.7] | 371 [14.6] | 1745 [68.7] | 1729 [68.1] | 2007 [79.0] | — | 376 [14.8] | 219 [8.6] | 707 [27.8] | 245 [9.6] |
| | | 11200 ⁽²⁾ DRW | LT215/85R16E | 520 [20.5] | 504 [19.9] | 629 [24.8] | 494 [19.5] | 856 [33.7] | 687 [27.0] | 1983 [78.1] | 1883 [74.1] | 205 [8.1] | 17 [0.7] | 177 [7.0] | 1143 [45.0] | 1271 [50.0] | 45 [1.8] | 229 [9.0] | 748 [29.4] | 355 [14.0] | 1745 [68.7] | — | 23.80 [93.7] | 1880 [74.0] | 379 [14.9] | 222 [8.7] | 664 [26.1] | 202 [8.0] |
| | 4379 [172.4] | 9900 ⁽¹⁾ | LT265/75R16E | 529 [20.8] | 515 [20.3] | 622 [24.5] | 505 [19.9] | 842 [33.1] | 698 [27.5] | 1964 [77.3] | 1880 [74.0] | 205 [8.1] | 24 [0.9] | 165 [6.5] | 1143 [45.0] | 1271 [50.0] | 45 [1.8] | 278 [10.9] | 781 [30.7] | 371 [14.6] | 1745 [68.7] | 1729 [68.1] | 2007 [79.0] | — | 376 [14.8] | 219 [8.6] | 707 [27.8] | 245 [9.6] |
| | | 11200 ⁽²⁾ DRW | LT215/85R16E | 524 [20.6] | 504 [19.9] | 627 [24.7] | 494 [19.5] | 850 [33.5] | 686 [27.0] | 1976 [77.8] | 1884 [74.2] | 205 [8.1] | 17 [0.7] | 177 [7.0] | 1143 [45.0] | 1271 [50.0] | 45 [1.8] | 229 [9.0] | 748 [29.4] | 355 [14.0] | 1745 [68.7] | — | 23.80 [93.7] | 1880 [74.0] | 379 [14.9] | 222 [8.7] | 664 [26.1] | 202 [8.0] |
| Super Duty F-350 Crew Cab 4x4 | 3967 [156.2] | 9900 ⁽¹⁾ | LT265/75R16E | 632 [24.9] | 604 [23.8] | 694 [27.3] | 561 [22.0] | 912 [35.9] | 745 [29.3] | 1958 [77.1] | 1878 [73.9] | 205 [8.1] | 77 @ [3.0] | 165 [6.5] | 1143 [45.0] | 1271 [50.0] | 45 [1.8] | 278 [10.9] | 781 [30.7] | 371 [14.6] | 1736 [68.4] | 1729 [68.1] | 2007 [79.0] | — | 285 [11.2] | 128 [5.0] | 715 [28.1] | 253 [10.0] |
| | | 11200 ⁽²⁾ DRW | LT235/85R16E | 622 [24.2] | 607 [23.9] | 694 [27.3] | 561 [22.0] | 912 [35.9] | 745 [29.3] | 2027 [79.8] | 1952 [76.8] | 205 [8.1] | 77 @ [3.0] | 177 [7.0] | 1143 [45.0] | 1271 [50.0] | 45 [1.8] | 259 [10.2] | 792 [31.2] | 375 [14.8] | 1736 [68.4] | — | 2405 [94.7] | 1880 [74.0] | 317 [12.5] | 160 [6.3] | 664 [26.1] | 202 [8.0] |
| | 4379 [172.4] | 9900 ⁽¹⁾ | LT265/75R16E | 628 [24.7] | 604 [23.8] | 720 [28.4] | 604 [23.8] | 941 [37.0] | 798 [31.4] | 1957 [77.0] | 1879 [74.0] | 205 [8.1] | 77 @ [3.0] | 165 [6.5] | 1143 [45.0] | 1271 [50.0] | 45 [1.8] | 278 [10.9] | 781 [30.7] | 371 [14.6] | 1736 [68.4] | 1729 [68.1] | 2007 [79.0] | — | 285 [11.2] | 128 [5.0] | 715 [28.1] | 253 [10.0] |
| | | 11200 ⁽²⁾ DRW | LT235/85R16E | 629 [24.8] | 607 [23.9] | 690 [27.1] | 561 [22.0] | 904 [35.6] | 745 [29.3] | 2027 [79.8] | 1955 [77.0] | 205 [8.1] | 77 @ [3.0] | 177 [7.0] | 1143 [45.0] | 1271 [50.0] | 45 [1.8] | 259 [10.2] | 792 [31.2] | 375 [14.8] | 1736 [68.4] | — | 2405 [94.7] | 1880 [74.0] | 317 [12.5] | 160 [6.3] | 664 [26.1] | 202 [8.0] |

DRW — Dual Rear Wheels

- (1) — 9700 lb California
- (2) — 11,000 lb California
- (3) — Height at base curb weight with standard springs
- (4) — Loaded height at spring rating with standard springs

- (5) — The Height Data shown represents dimensions of a base/standard vehicle with no options.
- (5) Actual height may vary due to production tolerances [completed vehicles only].
- (6) — Distance from Pickup Box Floor to Frame Datum Line is 211 [8.3] at front, 199 [7.8] at rear.
- (7) — AA is measured at 80 psi for all season tire.
- (8) — BB/CC are measured at design at 60 psi.
- Static load rating of design and curb weight are taken at 60 psi.

@ — The top of the spring seat is below datum line.

- *H — Top of frame at \mathcal{C} of rear axle to top of tire in jounce
- *L — From outside edge of shackle eyebolt
- *W — From frame to top of tire in jounce

NOTES — [] DIMENSIONS ARE IN INCHES.

- F AND R VEHICLE HEIGHT DIMENSIONS ARE FROM GROUND TO FRAME DATUM LINE.
- LH IS FROM GROUND TO TOP OF FLOOR RIBS.